

Strukturzelt – 10 x 30 m – 3 Masten – 300 m²

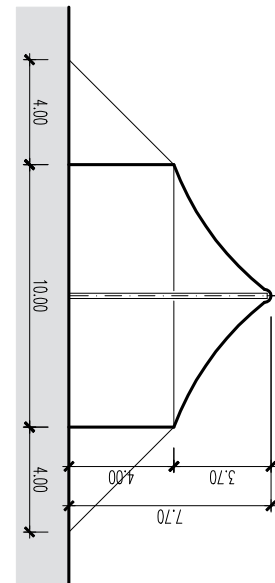

Infos

- Masse 10 x 30 m
- Fläche 300 m²
- Seitenhöhe 4 m
- Höhe (innen) bis 7.7 m
- Anzahl Masten 3 Stk.
- Blachenfarbe aussen blau-rot
- Blachenfarbe innen blau

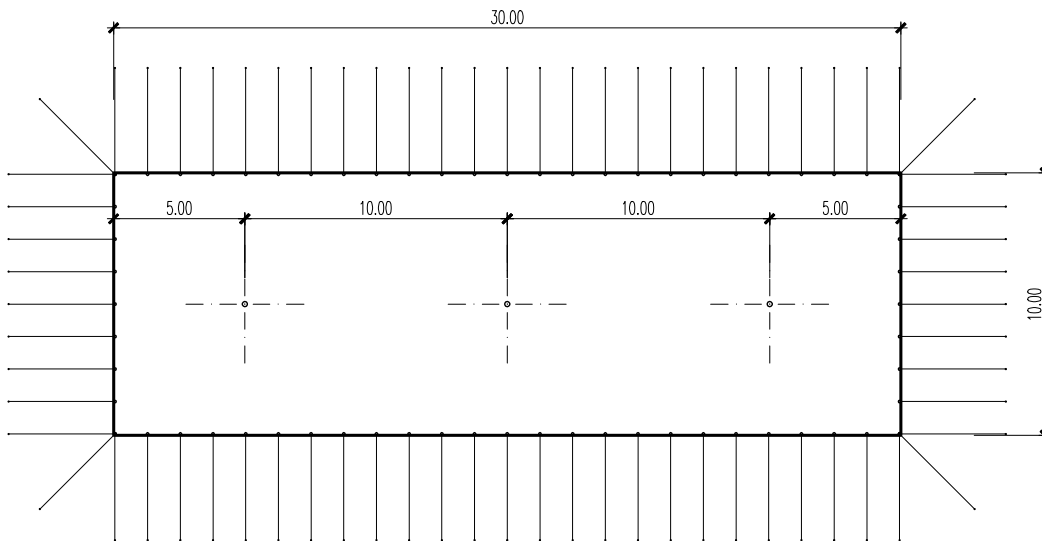
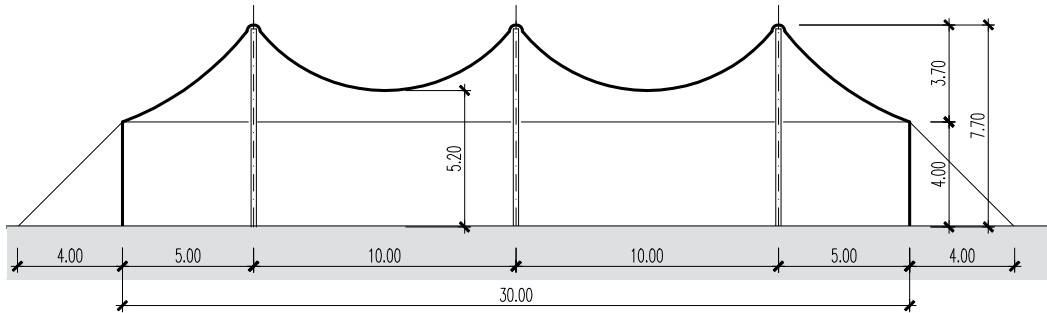

Strukturzelt – 10 x 30 m – 3 Masten: Grundriss

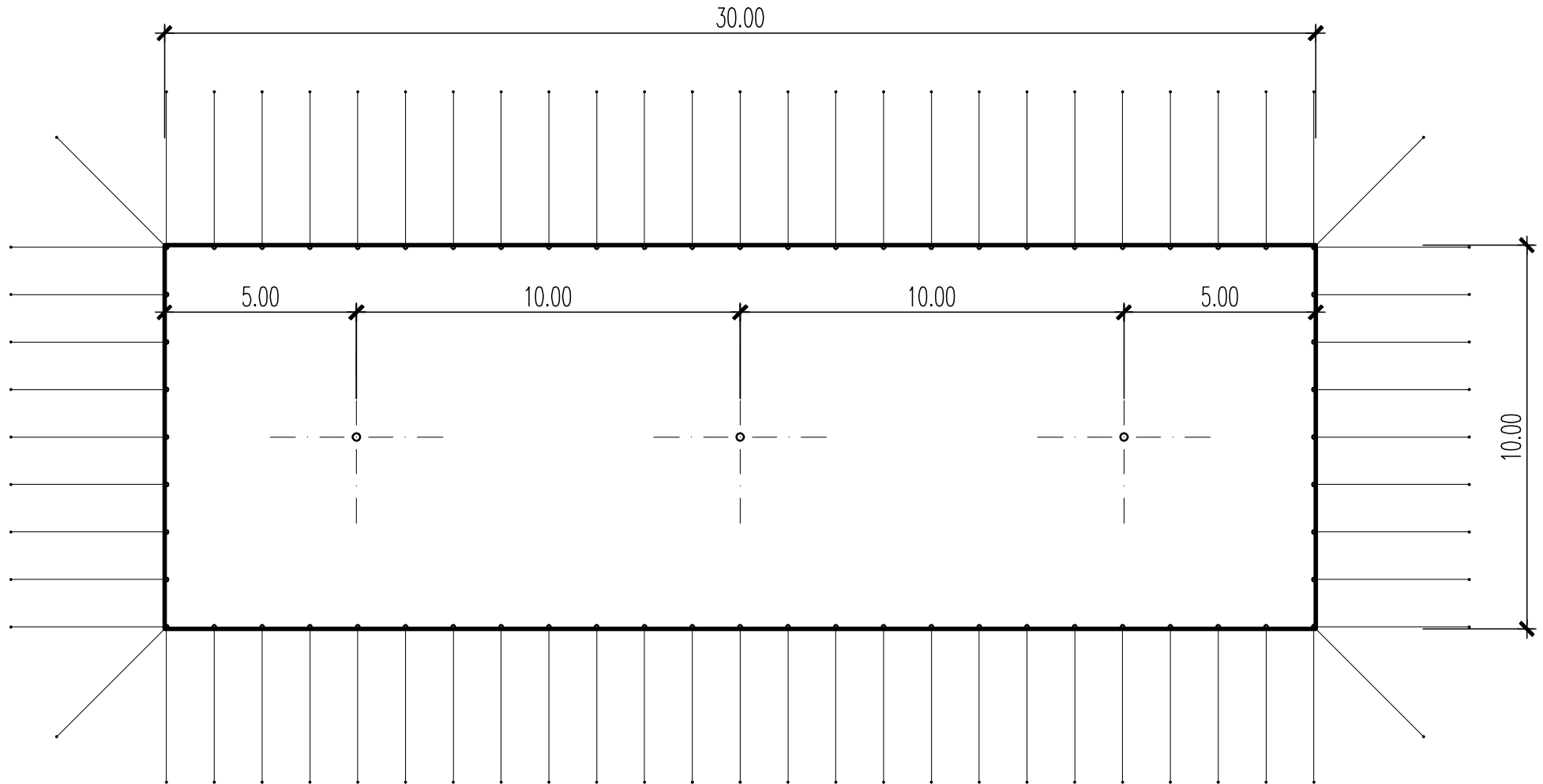



Strukturzelt – 10 x 30 m – 3 Masten: Längsschnitt

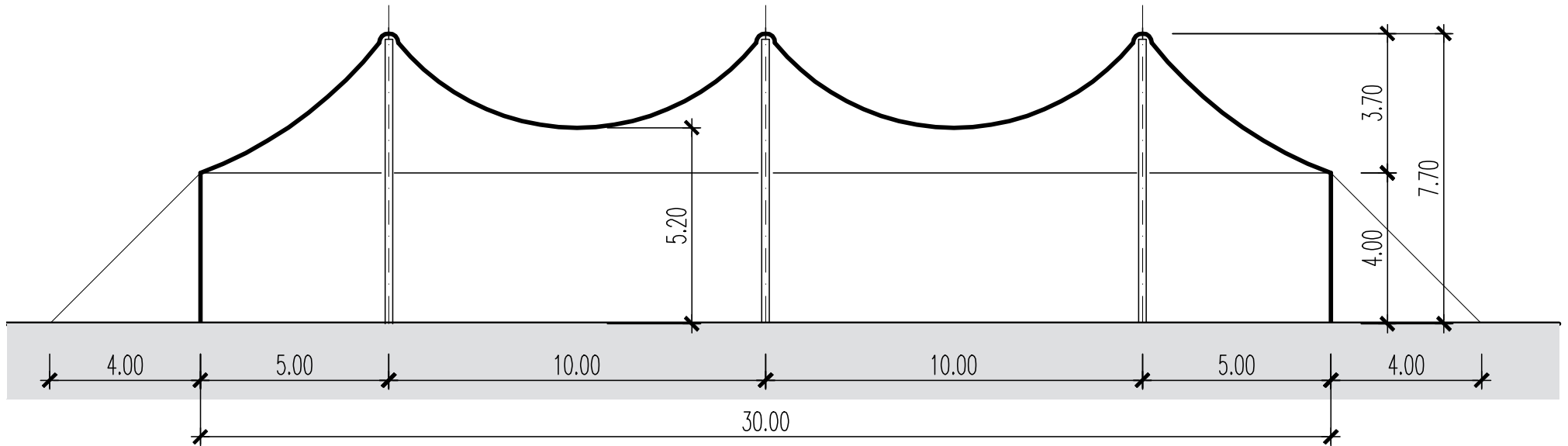

Strukturzelt – 10 x 30 m – 3 Masten: Querschnitt

